

Adjustable

DTD Series



DAMPTAC

Industrial Shock Absorber

The DAMPTAC large DTD series is widely used in heavy load applications. The design with reinforced high strength materials and the maximum absorption of energy can provide five-star safety protection for machines and effectively protect them from heavy load impact. Meanwhile, the exquisite adjustment knob design makes the shock absorber can be adjusted without dismantling during the application, which is very convenient.

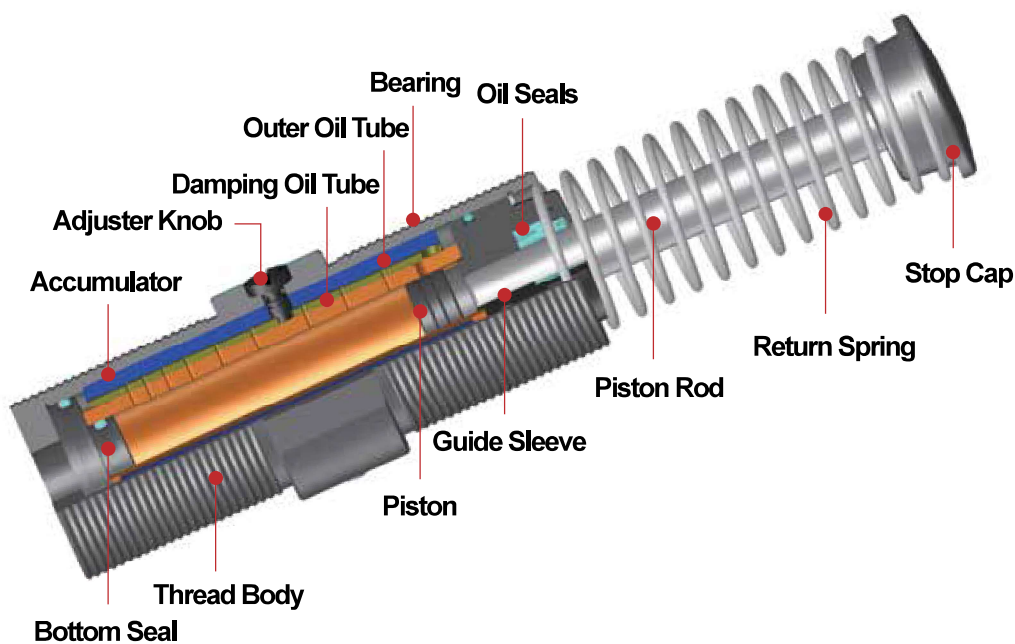

Properties

- DTD model is adjustable type so you could control the damping force according to impact velocity. DTD model has the 8 steps range to rotate the dial from "0" to "8" so it is possible to get the fine tuning according to the application.
- DTD model provides you with "NO STOP of production line" for the adjustment. It can greatly simplify the maintenance and improve the efficiency.
- The thread body provides reliable, accurate installation and the increased contact area promotes heat dissipation into the air.
- The piston rod uses reinforced stainless steel, the bearing uses high strength and wear-resistant materials, the seal uses special materials and the unique fast heat dissipation design ensure the long life time of the shock absorber.
- Impacting Velocity: 0.3 ~ 5.0m/s (standard type), 0.08 ~ 1.3m/s (low velocity type)
- Environment Temperature: -10 °C ~ +80 °C , -40 °C ~ +120 °C (special type)

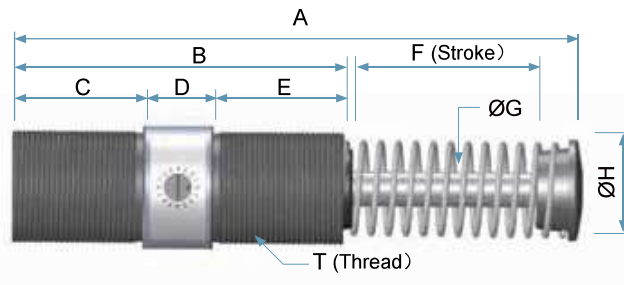

Specifications Chart - Large DTD Series

| Type | Stroke (mm) | Max. Energy /Cycle (Nm) | Max. Energy /Hour (Nm/h) | Effective Weight (kg) | Return Force (N) | | Weight (kg) |
|------------|-------------|-------------------------|--------------------------|-----------------------|------------------|------|-------------|
| | | | | | Ext | Comp | |
| DTD85-50 | 50 | 2,300 | 370,000 | 200-37,000 | 148 | 315 | 6.4 |
| DTD85-90 | 90 | 4,000 | 650,000 | 230-40,000 | 121 | 365 | 7.6 |
| DTD85-125 | 125 | 5,700 | 930,000 | 300-43,000 | 114 | 365 | 8.6 |
| DTD85-165 | 165 | 7,300 | 1,210,000 | 360-45,000 | 98 | 429 | 9.8 |
| DTD115-50 | 50 | 3,700 | 1,501,000 | 370-44,000 | 187 | 427 | 16 |
| DTD115-100 | 100 | 7,400 | 1,805,000 | 370-57,000 | 178 | 482 | 19 |
| DTD115-150 | 150 | 11,100 | 2,100,000 | 370-89,000 | 185 | 538 | 21 |
| DTD115-200 | 200 | 14,800 | 2,405,000 | 390-118,000 | 185 | 665 | 31 |
| DTD115-250 | 250 | 18,500 | 2,710,000 | 440-145,000 | 184 | 649 | 34 |

Dimensions Chart - Large DTD Series

| Type | Dimensions (Unit: mm) | | | | | | | | |
|------------|-----------------------|-----|-----|----|-----|-----|----|----|----------|
| | A | B | C | D | E | F | G | H | T |
| DTD85-50 | 245 | 140 | 42 | 50 | 48 | 50 | 25 | 58 | M85x2.0 |
| DTD85-90 | 325 | 180 | 60 | 50 | 70 | 90 | 25 | 58 | |
| DTD85-125 | 400 | 216 | 82 | 50 | 84 | 125 | 25 | 58 | |
| DTD85-165 | 494 | 256 | 106 | 50 | 100 | 165 | 25 | 58 | |
| DTD115-50 | 314 | 200 | 75 | 50 | 75 | 50 | 35 | 98 | M115x2.0 |
| DTD115-100 | 414 | 250 | 100 | 50 | 100 | 100 | 35 | 98 | |
| DTD115-150 | 514 | 300 | 125 | 50 | 125 | 150 | 35 | 98 | |
| DTD115-200 | 644 | 350 | 150 | 50 | 150 | 200 | 35 | 98 | |
| DTD115-250 | 744 | 410 | 180 | 60 | 170 | 250 | 35 | 98 | |

DTD Series Ordering Information

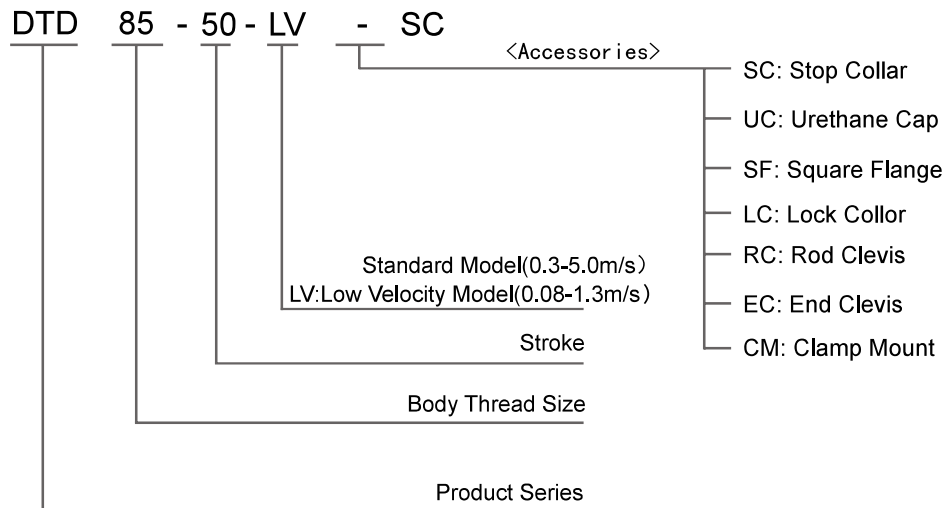

Example: DTD85-50 (Thread M85, Stroke 50mm, Standard With Steel Cap)

Note: DTD series standard with no lock collor, need to be purchased separately

Accessories Specification Chart

1. Lock Cap



| Type | A | B | C | H | T |
|-------|-----|-----|----|----|----------|
| LC85 | 110 | 100 | 10 | 16 | M85x2.0 |
| LC115 | 150 | 138 | 14 | 20 | M115x2.0 |

2. Urethane Cap

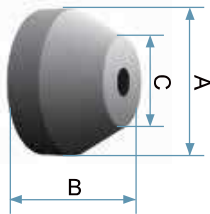

| Type | A | B | C |
|-------|-----|----|----|
| UC85 | 80 | 30 | 54 |
| UC115 | 110 | 31 | 75 |

3. Square Flange

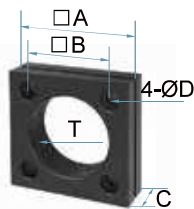

| Type | A | B | C | D | T |
|-------|-----|-----|----|----|----------|
| SF85 | 104 | 78 | 19 | 13 | M85x2.0 |
| SF115 | 140 | 111 | 19 | 13 | M115x2.0 |

4. Clamp Mount

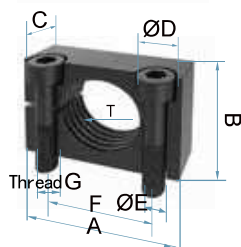

| Type | A | B | C | D | E | F | G | T |
|-------|-----|-----|----|----|------|-----|-----|----------|
| CM85 | 120 | 100 | 30 | 22 | 15 | 98 | M14 | M85x2.0 |
| CM115 | 180 | 140 | 30 | 26 | 17.5 | 135 | M16 | M115x2.0 |